



Sadat City Master Plan

Egypt

CLIENT:

Egyptian Ministry of Housing and Reconstruction

Sadat City is a new community planned for 500,000 people located midway between Cairo and Alexandria. Development of this region is a fundamental part of a national strategy to direct growth away from the overcrowded cities of Cairo and Alexandria, save the rich agricultural land in the Nile Delta, which was rapidly being urbanized, and further Egypt's economic growth.

Sadat City's location near national markets and existing transportation systems made it an ideal new industrial center. KSK, acting as lead planners, coordinated the team of Egyptian and American engineers, architects, economists, sociologists, and industrial specialists. The plan provides a simple framework of infrastructure so that the town's rapid growth can be readily accommodated.

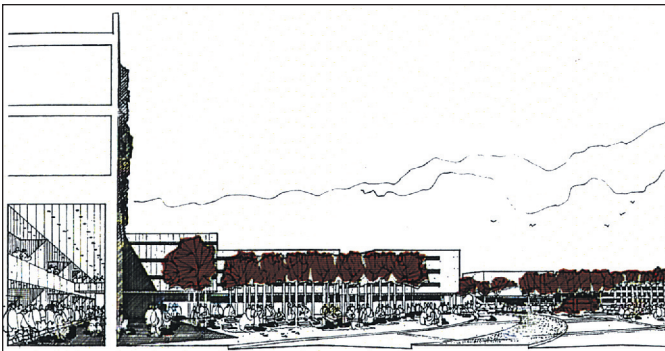

Perspective view of public space

The master plan features a hierarchy of spines, which serve as an organizing framework for the new community. A central spine directs the new city's growth in a southwest to northeast direction, taking advantage of cooling northwest winds. A secondary spine containing heavy industry is located downwind of the city, with ready access to the regional transportation system. These two major spines are intersected by a series of district spines, and regularly spaced cross-town arterials, which permit efficient circulation and utility systems and flexible internal development.

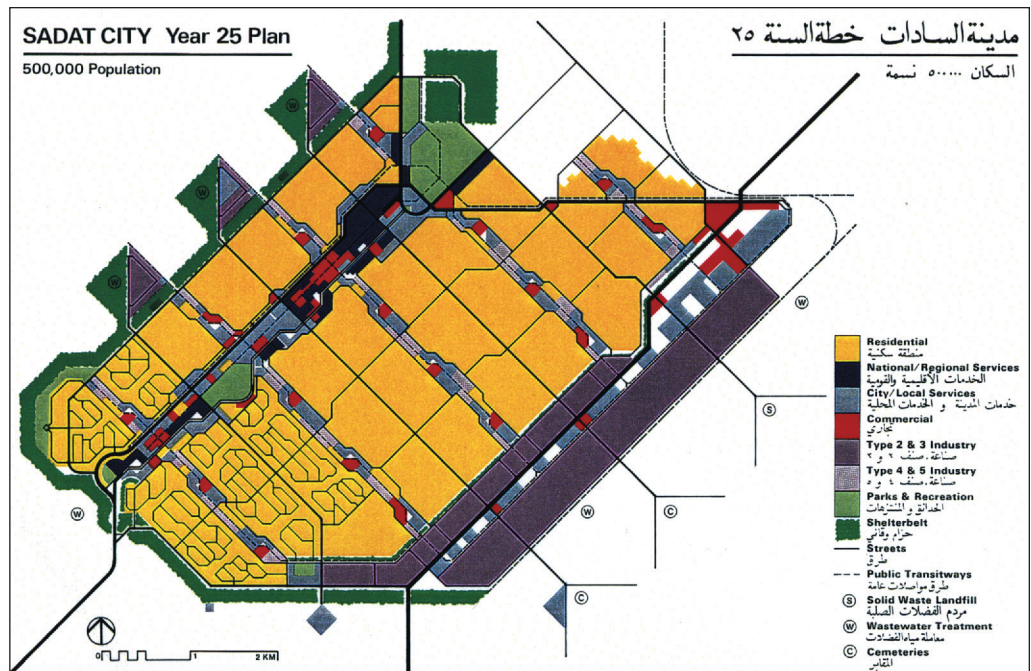

Master plan